

## Hollandia 300 NSG

The Next Generation Power Spoiler Sunroof



### Key Product Features

- **Large roof cutout.** Introduces a lot of fresh air and light.
- **Protection from UV rays.** Tinted protective Venus glass reflects UV radiation and solar heat, without impacting the amount of light coming into the vehicle.
- **Customizable to existing vehicle interior.** Standard trimshells come in at least 4 design variations and a sleek switch illuminated in various LED colors, enabling optimal integration of our roof into most interior looks.
- **Quiet and convenient.** Powered by an electric motor that is compact and the quietest of its kind.

# Why Next Generation?

The Hollandia 300 NSG features a large glass panel and sleek profile. The NSG was originally developed according to OE standards, which will optimize the look of the vehicle interior and exterior to maintain a factory look and feel. The NSG features pre-assembled components to capitalize on installation time.

There are currently three headliner solutions featured among the Entry Level, Comfort Level and Softwrap NSG models as well as two exterior roof frame options to choose from. To top it off, the new Hollandia 300 NSG will now be operated by a sleek switch featured on Webasto's newest models of sunroofs.

## Measurements and Dimensions

Dimensions	
A	22.4 in (568.8 mm)
B	32.1 in (814 mm)
C	2.3 in (60 mm)
D	29.5 in (748 mm)
E	17.7 in (448 mm)
F	19.5 in (494 mm)
G	31.2 in (794 mm)
R (X)	216.5 in (5,500 mm)
R (Y)	233.9 in (6,500 mm)
Visible glass aperture without sun rollo	13.8 x 23.6 in (350 x 600 mm)
Visible glass aperture with sun rollo	13 x 23.6 in (330 x 600 mm)
Sliding aperture	9 x 23.6 in (230 x 600 mm)
Frame dimensions (drive at the front)	24 x 33.4 in (609 x 848 mm)
Frame dimensions (drive at the rear)	24.9 x 33.4 in (630 x 848 mm)

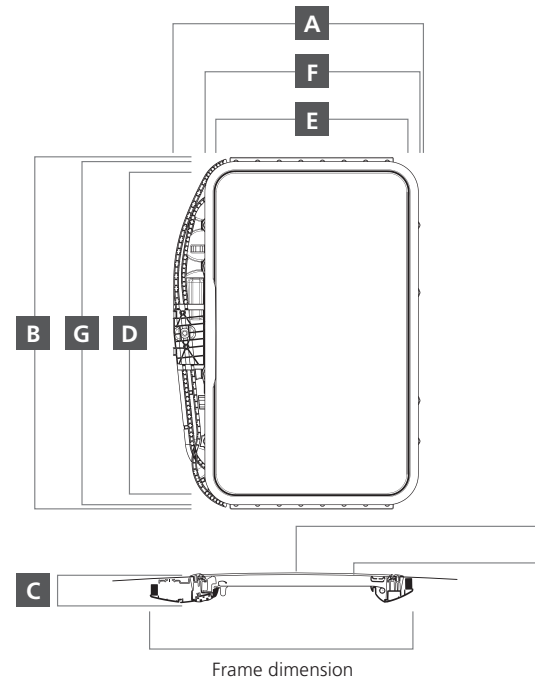

\*\*To provide for optimal positioning, the NSG can be delivered with the motor in the front or rear part of the frame component. The dimensions of the spoiler roof are identical in both versions.



Webasto gives a 3-year guarantee as of the date of installation, with a maximum of 4 years following the date of manufacturing. Installation, service and repairs should be performed by a certified Webasto service partner in accordance with Webasto specifications.



## Choose your interior look.

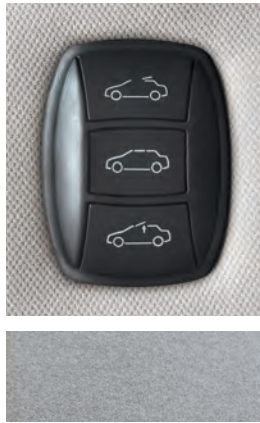

### Entry version

- Trimshell – flocked (gray)
- Switch offered in black without back lighting

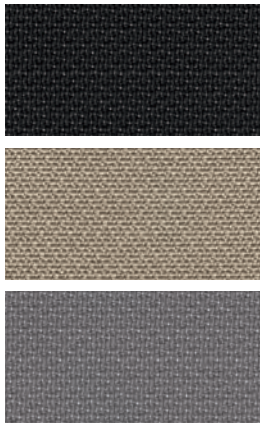

### Comfort version

- Trimshell covered in gray, beige or black fabric and featuring a grained black plastic cover cap
- Option of covering the trimshell with individual fabric as per customer wishes and to also customize the plastic cover cap
- Switch offered in black with chrome trim, available in a choice of four LED lighting colors
- Rollo Sunshade
- Wind Deflector
- One-touch/Auto-Close

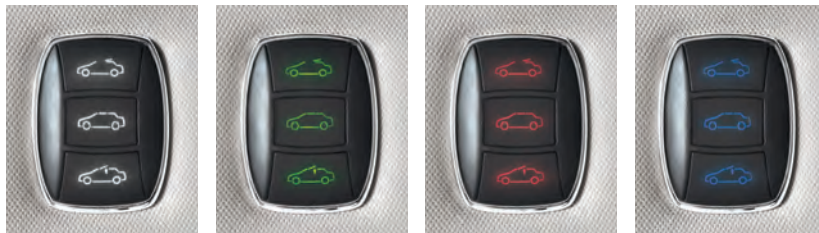

## Choose your exterior look.

The standard Hollandia 300 NSG is delivered with a black trim ring. However, for vehicles with chrome-accented window frames, roof rails, rear-view mirrors or other features, Webasto offers the option of selecting a chrome trim. This option appeals to the exterior look of many vehicles.





# Installation: Step-by-Step

With a goal of creating a more efficient installation process, Webasto engineered a system in which parts are pre-assembled and minimal additional pre-assembly is required. Additionally, this will help in avoiding errors during installation.

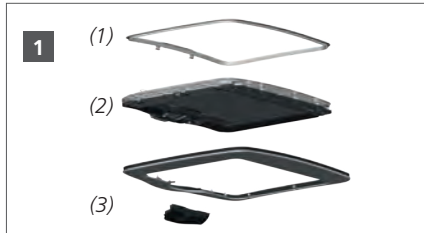

*Preassembled scope of delivery*  
(1) Roof frame  
(2) Basic element  
(3) Trimshell (including cover cap and switch)



*Optimal positioning of the roof frame (1) in the vehicle's roof skin and headliner.*



*Insertion and securing of the roof frame (1). No adhesives required.*



*Fitting of the spoiler roof's basic element (2) into the available 2 hooks at the front of the roof frame (1).*



*Bolting of the basic element (2) to the roof frame (1) with 24 pre-installed screws.*



*Insertion and connection of the spoiler roof's cable harness with the vehicle's electrical equipment (use of specific plugs is possible).*



*Attaching the trimshell (3) to the basic element (2) with 2 screws at the front and subsequently with 14 clips located in the trimshell.*



*Insertion of the switch into the cover cap. Connecting it with electrical plug and insertion of the cover cap in the trimshell (3).*



*Completing functional test and quality control.*

Webasto Thermo & Comfort  
North America, Inc.  
15083 North Road  
Fenton, Michigan 48430  
USA

Toll Free: 800-860-7866  
Phone: 810-593-6000  
Fax: 810-593-6001



[www.webastosunroofs.com](http://www.webastosunroofs.com)

*The world's largest manufacturer of OEM and Aftermarket sunroofs*